

# TREK3 INSTALL GUIDE

RV battery monitor Trek3 is a smart battery monitor able to learn the actual battery capacity with time and provide more accurate feedback to the user. It combines comprehensive battery data together with water tank level measurement on one screen in a sleek design.

Trek3 is designed to work with BatteryPlus35 battery management system. Connected to the BatteryPlus35 via CAN bus, it continuously monitors information providing vital data at a glance.

## 1. PARTS

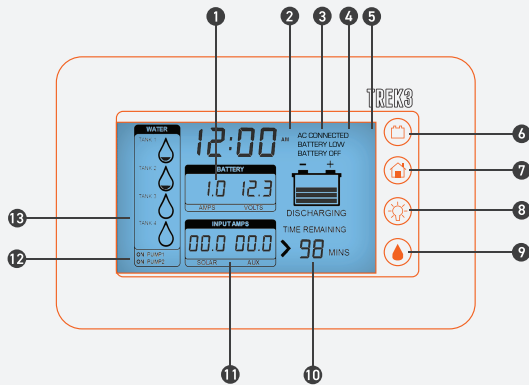

1. Battery Information
2. Battery Capacity Bar Graph
3. AC Connected: Appears when connected to AC mains
4. Battery Low: Appears when battery voltage is low.
5. Battery Off: Appears BatteryPlus35 has entered ECO Mode.
6. Battery Button: Enables ECO Mode.
7. Home Button: Enters Set-up Mode.
8. Backlight Button
9. Water Pump Button
10. Time Remaining
11. Input Amps
12. Water Pump Status
13. Tank Level Indicators

## 2. MOUNTING

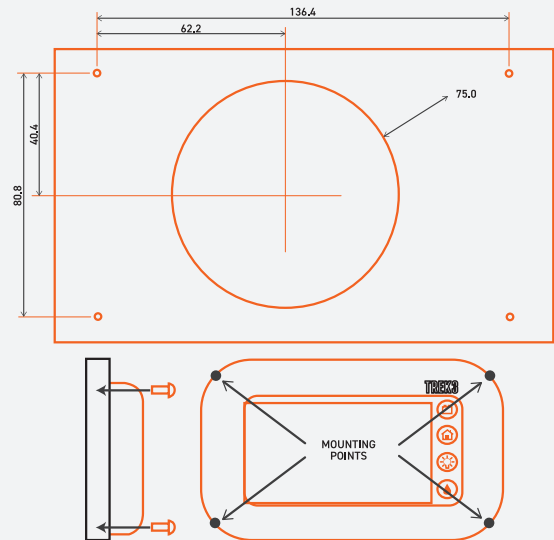

To mount the Trek3:

1. Drill holes in the wall for the connectors.
2. Use flat head screws with a maximum diameter of 4.0mm to mount the Trek3 to the wall.
3. Connect the Trek3 to the wall using the provided connectors.
4. Attach the provided fascia cover to the Trek3.

## 3. SET UP MODE

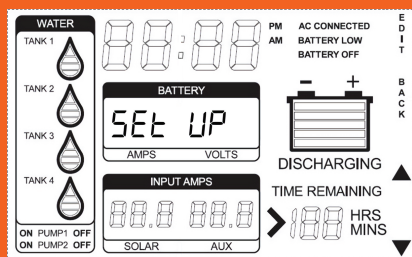

Set-up mode allows you to configure the Trek3. To enter Set-up mode, hold down the Home Button until SET UP is seen on the Battery display.

1. & 6. Menu Function Display: Displays various Set-Up menu functions and information.
2. Edit: Use the Battery button to edit.
3. Back: Use the Home button go back.
4. & 5. Scroll Arrows: Use the Backlight and Water Pump buttons to scroll.

To exit Set-up mode, repeatedly press the Back button.

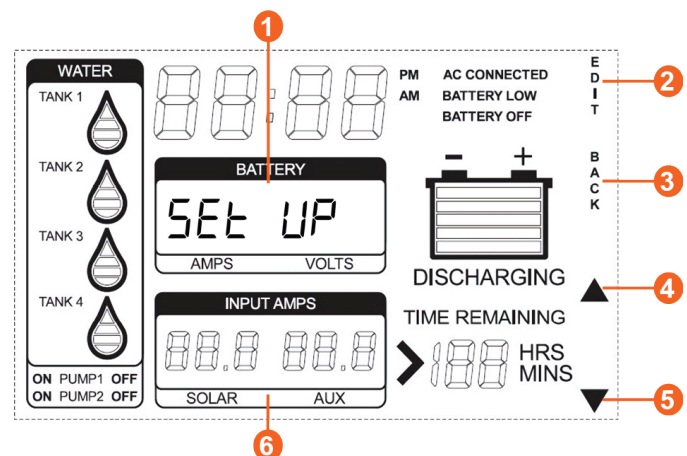

## 4. CONFIGURING BATTERY CAPACITY

To configure the battery capacity:

1. Enter Set-Up mode.
2. Navigate to the batCaP menu function.
3. Press Edit.
4. Use the Scroll Arrow buttons to set the correct battery capacity.

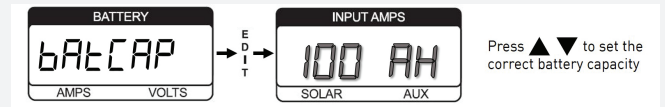

## 5. CONFIGURING BATTERY CHEMISTRY

If you have a lithium battery and a BatteryPlus35-HA, you will need to configure the battery chemistry to lithium.

1. To configure the battery chemistry:
  1. Enter Set-Up mode.
  2. Select the AdvAnC menu function.
  3. Navigate to the bAtCHM menu function.
  4. Press Edit.
  5. Use the Scroll Arrow buttons to set the correct battery chemistry

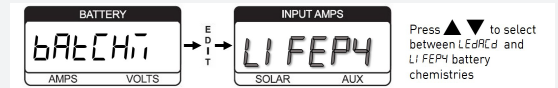

## 5. CONFIGURING WATER TANKS

To enable water tank monitoring:

1. Enter Set-Up mode.
2. Navigate to the tAnKS menu function.
3. Press Edit.
4. Use the Scroll Arrow buttons to select the desired tank.
5. Press Edit.
6. Use the Scroll Arrow buttons to enable or disable the selected tank.

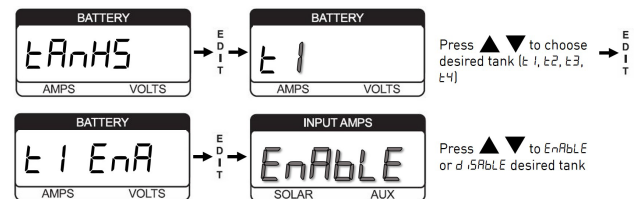

To configure the water tank type:

1. Enter Set-Up mode.
2. Navigate to the tAnKS menu function.
3. Press Edit.
4. Use the Scroll Arrow buttons to select the desired tank.
5. Press Edit.
6. Use the scroll arrows to change to tYP.
7. Press Edit.
8. Use the Scroll Arrow buttons to set the tank to CLEAN or dirty.

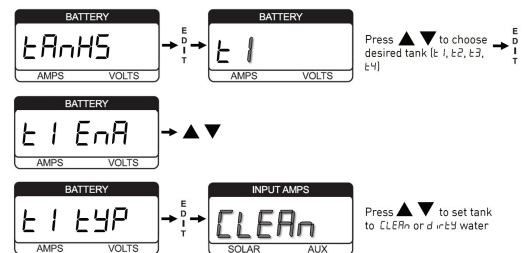

## 6. CONFIGURING THE CLOCK

To configure the clock for 12-hour time:

1. Enter Set-Up mode.
2. Navigate to the CLOCK menu function.
3. Press Edit.
4. Press Edit again.
5. Use the scroll arrows to set the hour.
6. Press Edit.
7. Use the scroll arrows to set the minute.

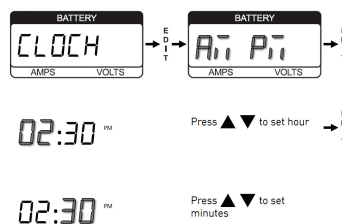

To configure the clock for 24-hour time:

1. Enter Set-Up mode.
2. Navigate to the CLOCK menu function.
3. Press Edit.
4. Use the scroll arrows to change to 24hrS.
5. Press Edit.
6. Use the scroll arrows to set the hour.
7. Press Edit.
8. Use the scroll arrows to set the minute.

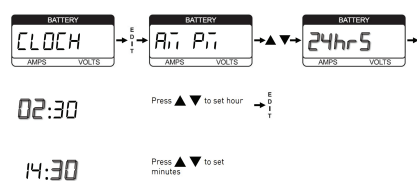

MANUAL



PRODUCT PAGE